

RF Switch (High Power)



Model: MSW2-160180H

Microot Microwave co., Ltd.

High Power SPDT RF Switch

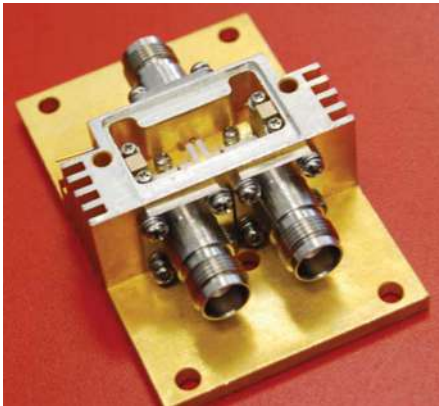

Control Way (Spst.....SP8T)

| TTL 3.3V (0 : ON ; 1 : OFF) | | | |
|------------------------------|----------------|-----------|---------|
| E | (0: ON; 1:OFF) | E4 | J0 - J4 |
| E1 | J0 - J1 | E5 | J0 - J4 |
| E2 | J0 - J2 | E6 | J0 - J5 |
| E3 | J0 - J3 | E7 | J0 - J6 |

Outline Drawing Unit: mm

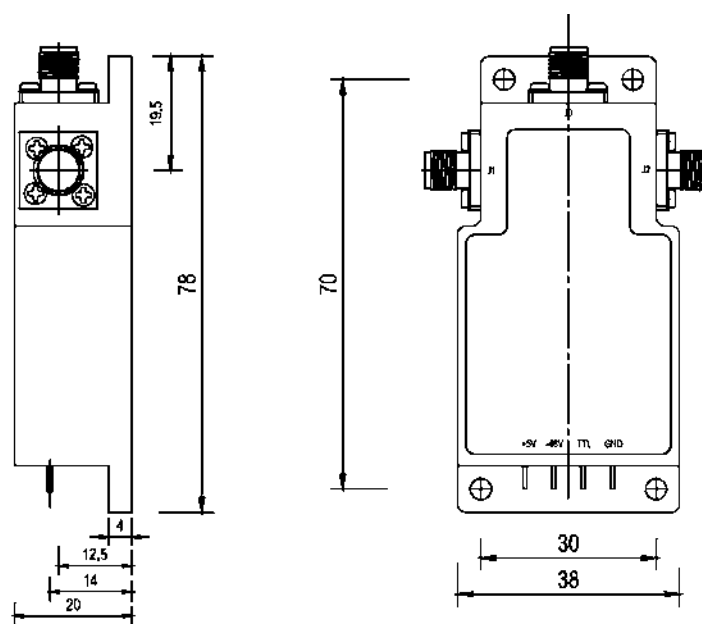

Elec. Spec. "50Ω"

[Inquiry](#)

| | |
|----------------------|-------------|
| Freq. Range (GHz) | 16-18 |
| IL (dB) Max | 1.2 |
| Isolator (dB) Min | 30 |
| VSWR Max | 1.5 |
| CW Power (W) Max | 120 |
| RF Switch Time Max | 900ns |
| TTL delay Time Max | 30ns |
| Power Supply (1) Typ | 200mA / 5V |
| Power Supply (2) Typ | 10mA / -48V |
| Operating Temp.(°C) | -20 ~ +70 |
| Connector | SMA-Female |
| Switch Type | / |