

RF Switch (High Power)



Model: MSW2-010020H

Microot Microwave co., Ltd.

High Power SPDT RF Switch

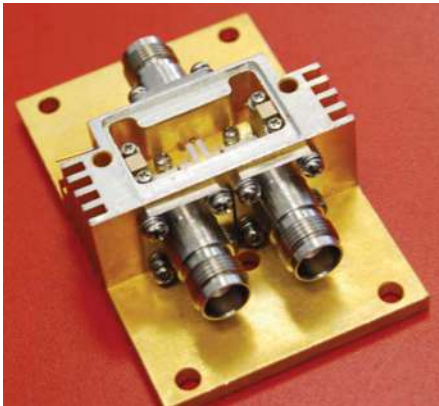

Control Way (Spst.....SP8T)

TTL 3.3V (0 : ON ; 1 : OFF)			
E	(0: ON; 1:OFF)	E4	J0 - J4
E1	J0 - J1	E5	J0 - J4
E2	J0 - J2	E6	J0 - J5
E3	J0 - J3	E7	J0 - J6

Outline Drawing Unit: mm

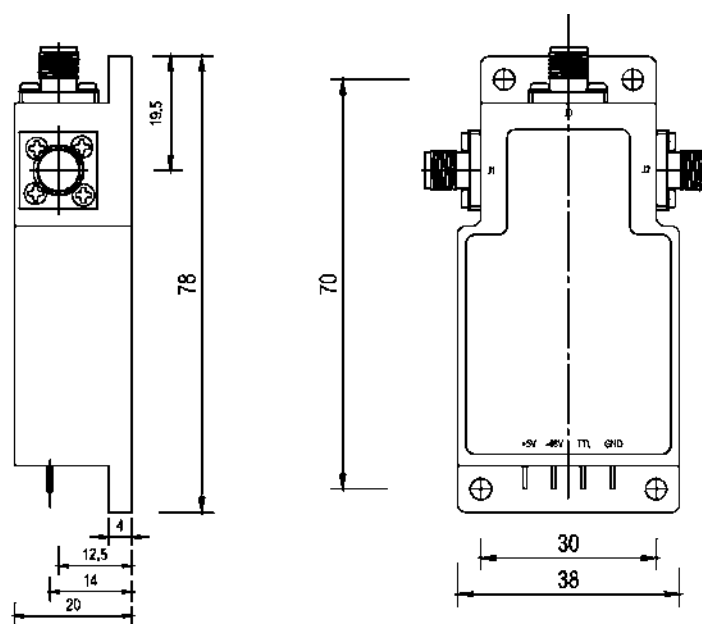

Elec. Spec. "50Ω"

[Inquiry](#)

Freq. Range (GHz)	1-2
IL (dB) Max	0.7
Isolator (dB) Min	30
VSWR Max	1.4
CW Power (W) Max	120
RF Switch Time Max	900ns
TTL delay Time Max	30ns
Power Supply (1) Typ	200mA / 5V
Power Supply (2) Typ	10mA / -48V
Operating Temp.(°C)	-20 ~ +70
Connector	SMA-Female
Switch Type	/