

# RF Switch (High Power)



Model: MSW2-002004H

Microot Microwave co., Ltd.

## High Power SPDT RF Switch

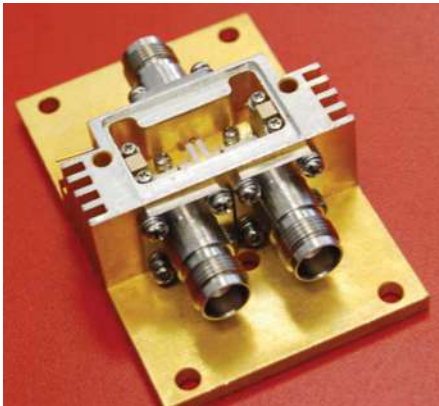

### Control Way (Spst.....SP8T)

TTL 3.3V ( 0 : ON ; 1 : OFF)			
<b>E</b>	(0: ON; 1:OFF)	<b>E4</b>	J0 - J4
<b>E1</b>	J0 - J1	<b>E5</b>	J0 - J4
<b>E2</b>	J0 - J2	<b>E6</b>	J0 - J5
<b>E3</b>	J0 - J3	<b>E7</b>	J0 - J6

### Outline Drawing Unit: mm

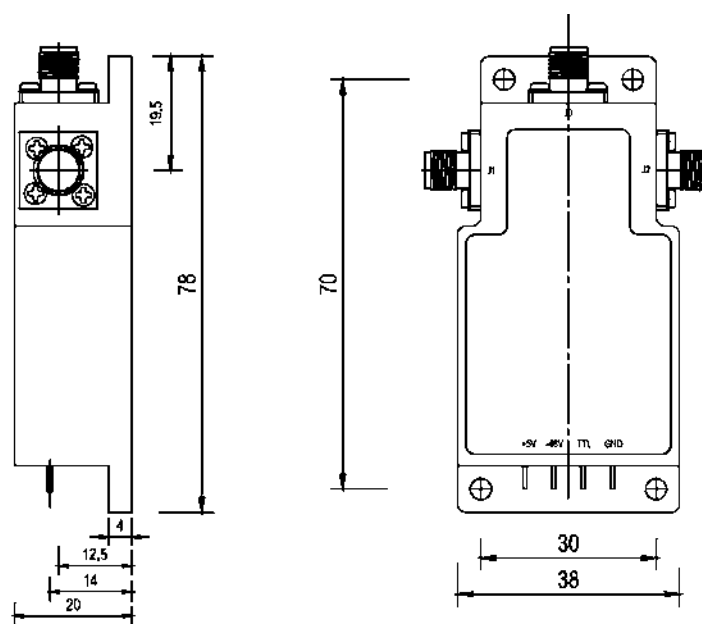

### Elec. Spec. "50Ω"

[Inquiry](#)

Freq. Range (GHz)	0.2-0.4
IL (dB) Max	1.0
Isolator (dB) Min	30
VSWR Max	1.5
CW Power (W) Max	50
RF Switch Time Max	10us
TTL delay Time Max	30ns
Power Supply (1) Typ	200mA / 5V
Power Supply (2) Typ	10mA / -48V
Operating Temp.(°C)	-20 ~ +70
Connector	SMA-Female
Switch Type	/